



Massive Graphics' display systems can be set up in a multitude of different configurations, from straight wall to curved and every variation in between. The 10' is the ideal size for exhibitors who need a little extra space to display their message. These systems are easy to use, and the wheeled transportation cases make them extremely portable.

The following options are available for all of our systems:

- Magnetically applied full graphic or fabric panels
- Straight or curved headers
- Internal & external shelves
- Case-to-podium conversion kits
- Other case styles with podium conversion options
- Bubble panels
- Trusses

See Accessories for additional options (section VI b)



Package Includes	Qty
10' Curved Frame	1
Mag Bars	7
Centre Panels	4
End Panels	2
200W Halogen Lights	2
Wheeled Transportation case (square)	2

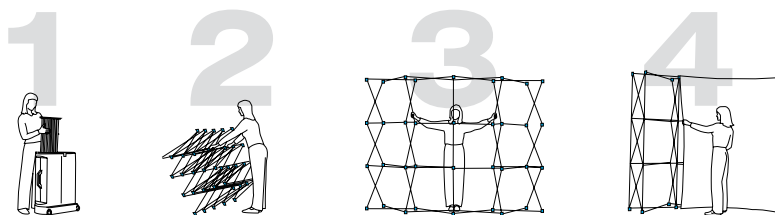

We offer a:

- Manufacturers warranty on tradeshow booth hardware.
- Two-year warranty on printed graphic panels.



225F Alison Blvd.
Fredericton, NB E3C 2S5
Ph: 506-457-6055
Toll Free: 888-634-4511
Fax: 506-457-6054
Email: info@massivegraphics.ca
www.massivegraphics.ca

To place orders call toll free 1-888-634-4511